

MATERIALE

» 2.0060 (E-Cu 57)

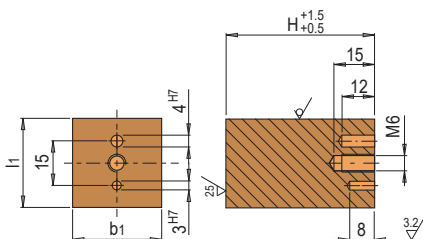

b1	l1	H	N°	EUR
10	30	30	V 91550/10/30/30	<>
10	30	50	V 91550/10/30/50	<>
10	40	30	V 91550/10/40/30	<>
10	40	50	V 91550/10/40/50	<>
10	50	30	V 91550/10/50/30	<>
10	50	50	V 91550/10/50/50	<>
15	30	30	V 91550/15/30/30	<>
15	30	50	V 91550/15/30/50	<>
15	40	30	V 91550/15/40/30	<>
15	40	50	V 91550/15/40/50	<>
15	50	30	V 91550/15/50/30	<>
15	50	50	V 91550/15/50/50	<>
20	20	30	V 91550/20/20/30	<>
20	20	50	V 91550/20/20/50	<>
20	20	70	V 91550/20/20/70	<>
20	30	30	V 91550/20/30/30	<>
20	30	50	V 91550/20/30/50	<>
20	30	70	V 91550/20/30/70	<>
20	40	30	V 91550/20/40/30	<>
20	40	50	V 91550/20/40/50	<>
20	40	70	V 91550/20/40/70	<>
20	50	30	V 91550/20/50/30	<>
20	50	50	V 91550/20/50/50	<>
25	25	30	V 91550/25/25/30	<>
25	25	50	V 91550/25/25/50	<>
25	25	70	V 91550/25/25/70	<>
25	30	30	V 91550/25/30/30	<>

b1	l1	H	N°	EUR
25	30	50	V 91550/25/30/50	<>
25	40	30	V 91550/25/40/30	<>
25	40	50	V 91550/25/40/50	<>
25	50	30	V 91550/25/50/30	<>
25	50	50	V 91550/25/50/50	<>
30	30	30	V 91550/30/30/30	<>
30	30	50	V 91550/30/30/50	<>
30	30	70	V 91550/30/30/70	<>
30	40	30	V 91550/30/40/30	<>
30	40	50	V 91550/30/40/50	<>
30	40	70	V 91550/30/40/70	<>
30	50	30	V 91550/30/50/30	<>
30	50	50	V 91550/30/50/50	<>
35	35	30	V 91550/35/35/30	<>
35	35	50	V 91550/35/35/50	<>
35	35	70	V 91550/35/35/70	<>
40	40	30	V 91550/40/40/30	<>
40	40	50	V 91550/40/40/50	<>
40	40	70	V 91550/40/40/70	<>
40	50	30	V 91550/40/50/30	<>
40	50	50	V 91550/40/50/50	<>
45	45	30	V 91550/45/45/30	<>
45	45	50	V 91550/45/45/50	<>
50	50	30	V 91550/50/50/30	<>
50	50	50	V 91550/50/50/50	<>
50	50	70	V 91550/50/50/70	<>

i Potete trovare i prezzi e le altre lunghezze nello shop online