

DESCRIZIONE DEL PRODOTTO

- » Per filettatura gas
- » Planetare

MATERIALE

- » 2.0060 (E-Cu 57)

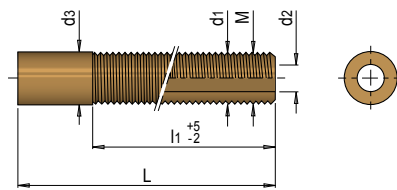

L	d1	d2	d3	M	l1	N°	EUR
120	8	4	8	G 1/8"	80	V 93120/1/8/80	<>
120	10	5	10	G 1/4"	80	V 93120/1/4/80	<>
120	14	7,5	14	G 3/8"	80	V 93120/3/8/80	<>
120	17	8	17	G 1/2"	80	V 93120/1/2/80	<>
120	23	10	20	G 3/4"	80	V 93120/3/4/80	<>
120	30	10	20	G 1"	80	V 93120/ 1/80	<>